

BYLAW 2020-15

(LU2020-08)

BEING A BYLAW OF WHEATLAND COUNTY TO AMEND LAND USE BYLAW NO. 2016-01 BY REDESIGNATING A PORTION OF NE-18-23-26-W4M FROM AGRICULTURAL GENERAL DISTRICT TO COUNTRY RESIDENTIAL DISTRICT.

WHEREAS the requirements for advertising this Bylaw, as per Section 606 of the *Municipal Government Act*, have been met prior to the public hearing date.

WHEREAS a Public Hearing was held on _____, 2020 at the Wheatland County office.

THEREFORE under the authority and subject to the provisions of the *Municipal Government Act*, as amended, the Council of Wheatland County enacts as follows:

1. Bylaw No. 2016-01, being the Land Use Bylaw is hereby amended by redesignating a portion of NE-18-23-26-W4M, from Agricultural General (AG) District to Country Residential (CR) District as shown on the attached Schedule 'A' forming part of this Bylaw.
2. This Bylaw comes into force when it receives third reading and is signed by the Reeve/Deputy Reeve and the CAO or Designate, as per the *Municipal Government Act*.

_____ **MOVED** First Reading of Bylaw 2020-15 on _____ this being a bylaw for the purpose of amending Land Use Bylaw No. 2016-01 to redesignate +/-5.00 acres within NE-18-23-26-W4M, from Agricultural General (AG) District to Country Residential (CR) District as shown on the attached Schedule 'A'.

Carried.

_____ **MOVED** Second Reading of Bylaw 2020-15 on _____ and it was

Carried.

_____ **MOVED** Third and Final Reading of Bylaw 2020-15 on _____ and it was

Carried.

Amber Link – Reeve

Brian Henderson – Chief Administrative Officer

SCHEDULE 'A'

Bylaw: 2020-15

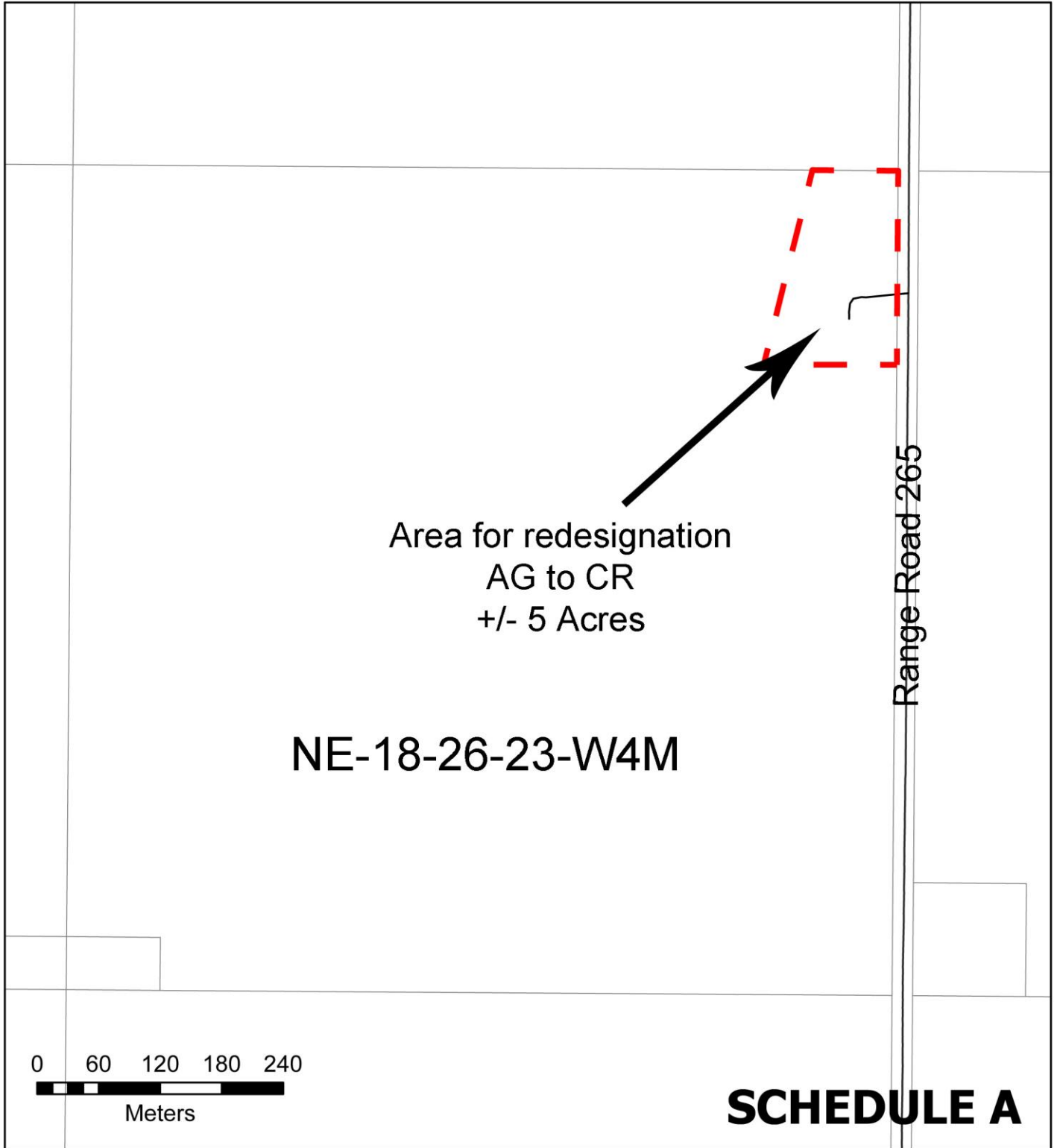

WHEATLAND COUNTY

Legal Description: NE-18-23-26-W4M

File No: LU2020-08

Division: 4

Title Area: +/- 5.00 acres

From: Agricultural General (AG) District

To: Country Residential (CR) District