

## BYLAW 2020-23

(LU2020-12)

**BEING A BYLAW OF WHEATLAND COUNTY TO AMEND LAND USE BYLAW NO. 2016-01 BY REDESIGNATING +/-62.53 ACRES WITHIN NE-23-25-17-W4M FROM AGRICULTURAL GENERAL DISTRICT TO NATURAL RESOURCE EXTRACTION DISTRICT.**

---

**WHEREAS** the requirements for advertising this Bylaw, as per Section 606 of the *Municipal Government Act*, have been met prior to the public hearing date.

**WHEREAS** a public Hearing was held on \_\_\_\_\_, 2020 at the Wheatland County office.

**THEREFORE** under the authority and subject to the provisions of the *Municipal Government Act*, as amended, the Council of Wheatland County enacts as follows:

1. Bylaw No. 2016-01, being the Land Use Bylaw is hereby amended by redesignating +/-62.53 acres within NE-23-25-17-W4M, from Agricultural General (AG) District to Natural Resource Extraction (NRE) District as shown on the attached Schedule 'A' forming part of this Bylaw.
2. This Bylaw comes into force when it receives third reading and is signed by the Reeve/Deputy Reeve and the CAO or Designate, as per the *Municipal Government Act*.

\_\_\_\_\_ **MOVED** First Reading of Bylaw 2020-23 on \_\_\_\_\_ this being a bylaw for the purpose of amending Land Use Bylaw No. 2016-01 to redesignate +/-62.53 acres within NE-23-25-17-W4M, from Agricultural General District to Natural Resource Extraction District as shown on the attached Schedule 'A'.

Carried.

\_\_\_\_\_ **MOVED** Second Reading of Bylaw 2020-23 on \_\_\_\_\_ and it was

Carried.

\_\_\_\_\_ **MOVED** Third and Final Reading of Bylaw 2020-23 on \_\_\_\_\_ and it was

Carried.

\_\_\_\_\_  
Reeve – Amber Link

\_\_\_\_\_  
Chief Administrative Officer-  
Brian Henderson

**SCHEDULE 'A'**  
**Bylaw: 2020-23**

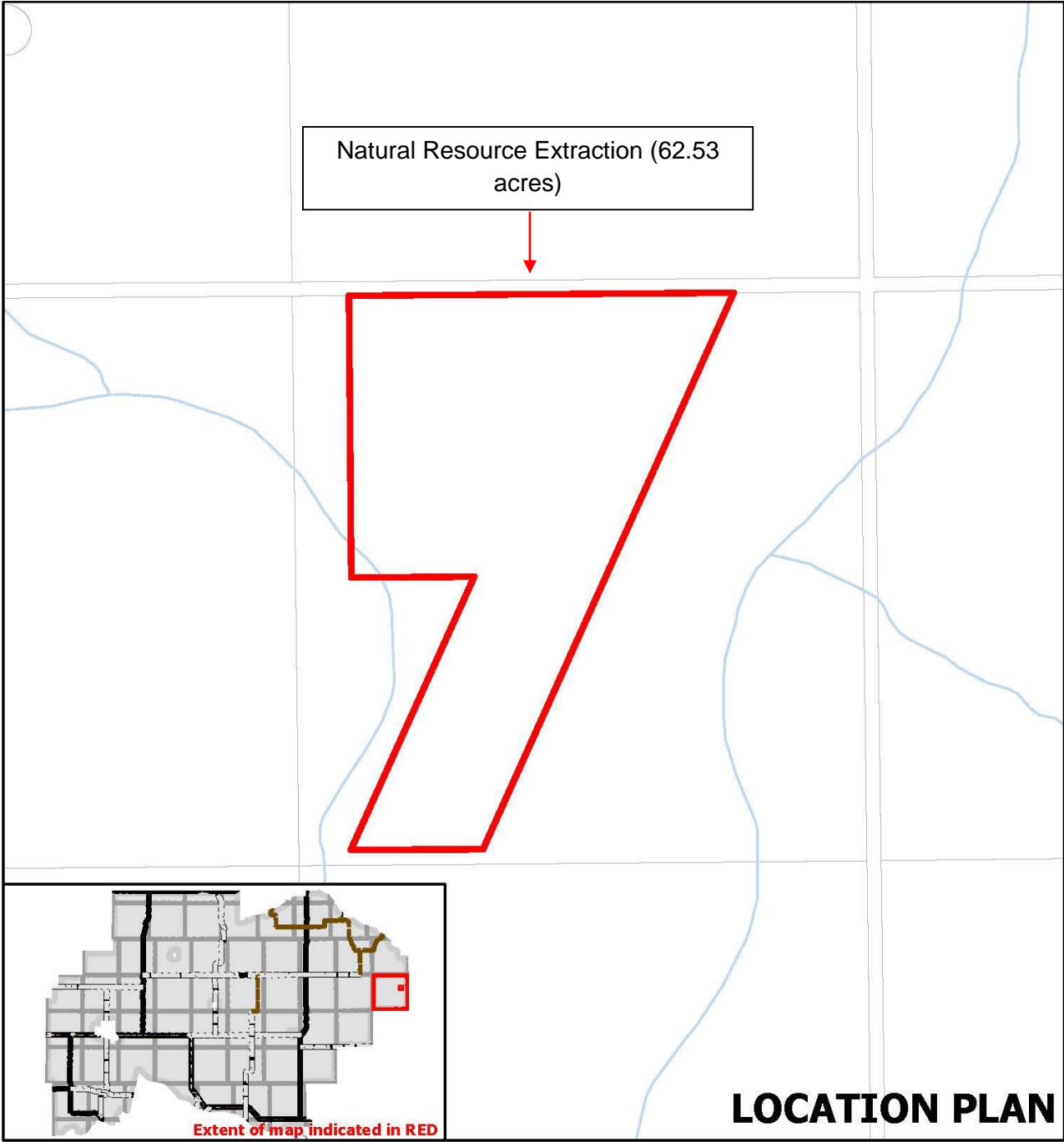

**WHEATLAND COUNTY**

**Legal Description:** NE-23-25-17-W4M  
**File No:** LU2020-12  
**Division:** 7  
**Title Area:** +/- 62.53 Acres  
**From:** Agricultural General (AG) District  
**To:** Natural Resource Extraction (NRE) District